



BERMUDA

REVENUE (APPOINTMENT OF CUSTOMS AREA) (DOCKYARD) NOTICE 2016

BR 22 / 2016

The Collector of Customs, in exercise of the power conferred by section 36(1) of the Revenue Act 1898 and after consultation with the West End Development Corporation, gives the following Notice:

Citation

1 This Notice may be cited as the Revenue (Appointment of Customs Area) (Dockyard) Notice 2016.

Interpretation

2 In this Notice—

“customs area” has the same meaning as in section 2 of the Revenue Act 1898;

“harbour” means any harbour, whether natural or artificial, any port, haven, estuary, tidal or other inland waterway navigated by sea-going ships, and includes a dock and a wharf;

“harbour area” means—

- (a) any harbour in Bermuda in respect of which the West End Development Corporation has statutory powers or duties of improvement, maintenance or management; and
- (b) any land which is adjacent to such a harbour and which is either land occupied by such corporation or land in respect of which such corporation has statutory power or duties of improvement, maintenance or management.

REVENUE (APPOINTMENT OF CUSTOMS AREA) (DOCKYARD) NOTICE 2016

Appointment and description of customs area

3 (1) The harbour and harbour area shown and outlined in red in the Schedule to this Notice, being the subject harbour and harbour area situate in the parish of Sandys and known as the Dockyard North Breakwater and South Basin, are hereby appointed as a customs area.

(2) The original of the plan and description of the subject harbour and harbour area, drawing reference # 5510/025/32, is available for inspection during office hours at the City of Hamilton customs house.

Revocations

4 Schedule (5) to the Appointment of Customs Areas (GN 146/1989) is revoked.

REVENUE (APPOINTMENT OF CUSTOMS AREA) (DOCKYARD) NOTICE 2016

---

SCHEDULE

(Paragraph 3)

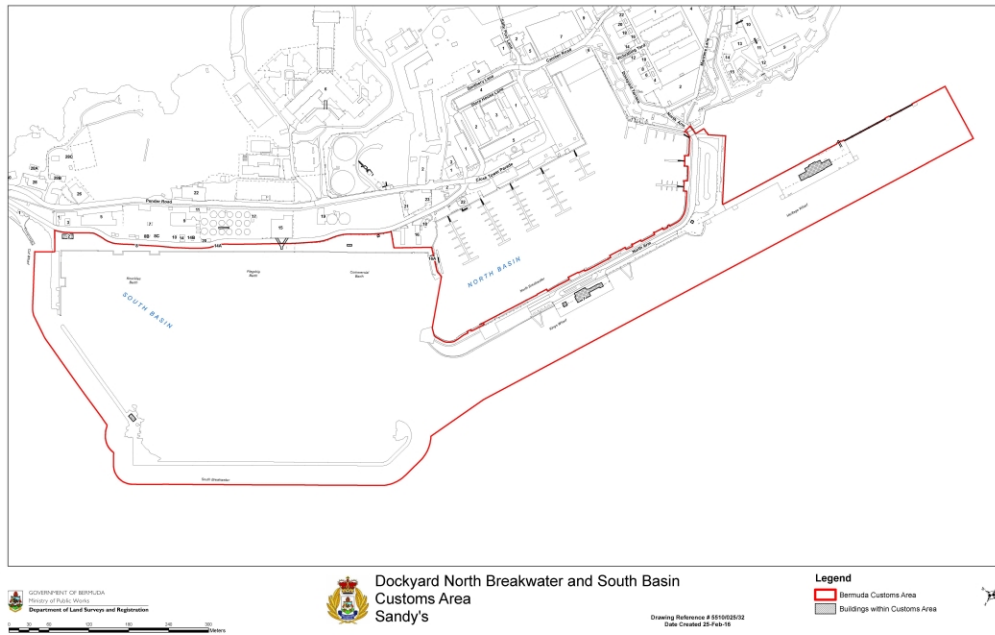

Made this 15th day of March 2016

Collector of Customs